

TOTAL EXTENT (LEAST EXTENT AS PER DOCUMENT) : 1295 SQ.M ✓
ROAD AREA : 264 SQ.M ✓
NO.OF.PLOTS : 6 Nos. ✓

NOTE:



1. SPLAY - 3.0M X 3.0M
2. MEASUREMENTS ARE INDICATED EXCLUDING SPLAY DIMENSION
3.  ROAD AREA WAS HANDED OVER TO THE LOCAL BODY VIDE GIFT DEED DOCUMENT NO.4410/2018, DATE: 02.05.2018, AND RECTIFICATION DEED DOCUMENT NO.15367/2018, DATE: 20.12.2018, @ SRO GUDUVANCHERY

CONDITION:

DR RULE NO : 29 (11)

THE COST OF LAYING IMPROVEMENTS TO THE SYSTEMS IN RESPECT OF ROAD, WATER SUPPLY, SEWERAGE, DRAINAGE OR ELECTRIC POWER SUPPLY THAT MAY BE REQUIRED AS ASSESSED BY THE COMPETENT AUTHORITY SHALL BE BORNE BY THE APPLICANT.

LEGEND:

-  SITE BOUNDARY
-  ROADS GIFTED TO LOCAL BODY
-  EXISTING ROAD

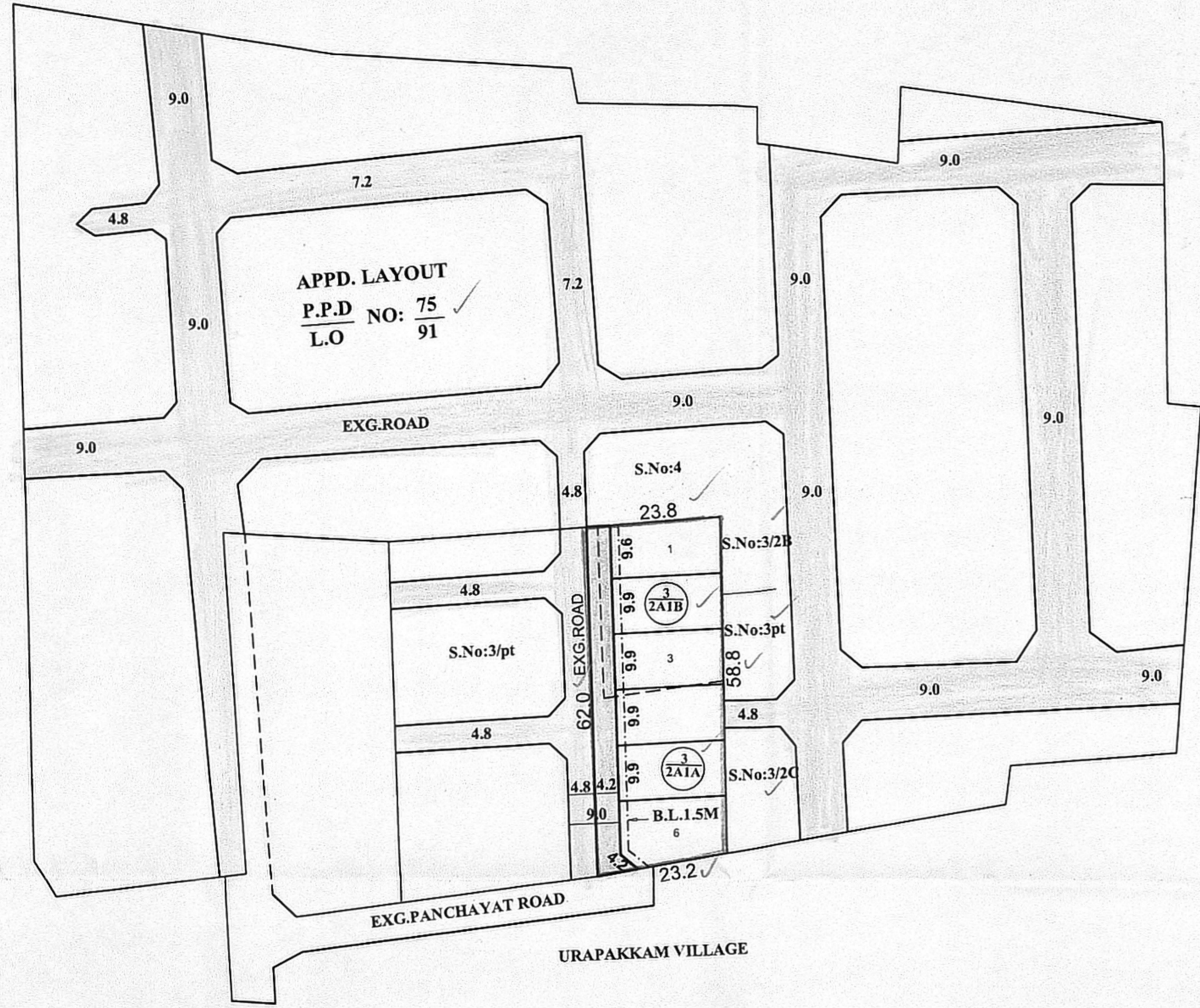

CONDITION:-
 THE SUB-DIVISION APPROVAL IS VALID SUBJECT TO OBTAINING SANCTION FROM THE LOCAL BODY CONCERNED

P.P.D NO. 11
L.O APPROVED 2019
 VIDE LETTER NO : L1 / 13195 / 2016
 DATE : / 01 / 2019

[Signature]
 FOR MEMBER SECRETARY
 CHENNAI METROPOLITAN
 DEVELOPMENT AUTHORITY

[Signature]
 PREPARED BY
 P.A.II
 30/11/19

[Signature]
 P.A.II

[Signature]
 A.P. 30/01/2019

KATTANKULATHUR PANCHAYAT UNION
SUB-DIVISION OF HOUSE SITES IN S.Nos: 3/2A1A AND 3/2A1B OF KILAMBAKKAM VILLAGE.
 SCALE - 1:800 (ALL MEASUREMENTS ARE IN METRE)

